

Technical data sheet

All right reserved Landa illuminotecnica S.p.A.
will reserve to change the specific note without
any written notice.

Wall Mira 65

| | |
|--|-------------------------|
| Article 4176LL5N.BRZ Natural White | 4176LL5H.BRZ Warm White |
| Product type: recessed wall light | |
| Body material Anodized aluminium AW 6060 | |
| Polycarbonate diffuser in opal finish and silicon gasket | |
| Dimmable: NO | |
| Recessed box is in a high density polyethylene with a security ring in nylon material loaded with 30% glass fibre. | |
| Ring in Aluminium AW 6060 anodized in bronze color | |
| 24V DC <u>Transformer not included</u> | |

IK08
IP66
Powered by
Cree XPG2

4176LL5N. BRZ 570lm 4000°K RA80
4176LL5H. BRZ 570lm 3000°K RA80

24V DC Transformer not included

Supplied with 1 mt. cable NS20N

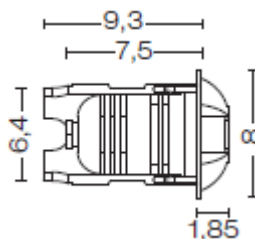

IP67 transformer available on request:
0409BT014 12W from 1 to 2 pcs.
0409BT015 25W from 1 to 4 pcs.

IP67 transformer on request:
0409BT016 100W from 1 to 16 pcs.

Accessories available on request:



code **0404M009**
Single connection IP68

